

# Cima Above Ceiling

## Standard and Optional Controls

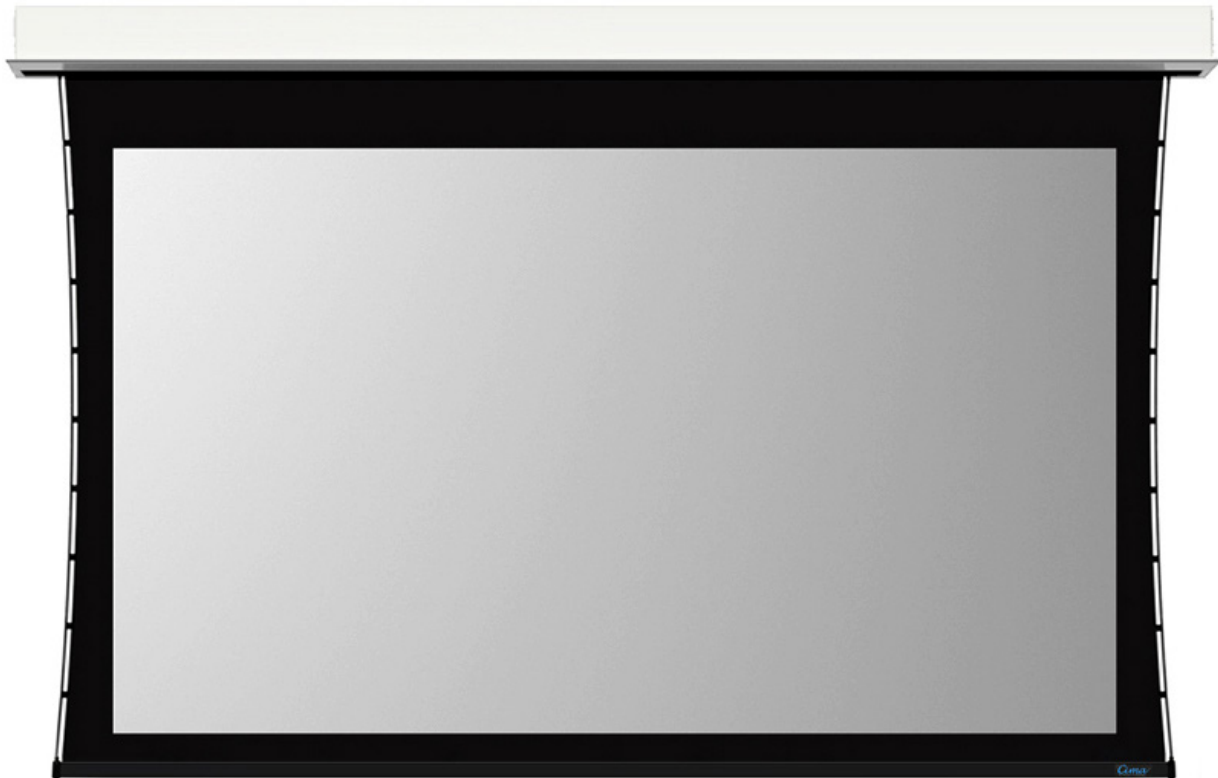

**Stewart**  
F I L M S C R E E N

The Reference for Stunning™

<b>Standard Control</b>		
Control	PowerOptions	Description
Cima Standard Control	120V / 220-240V	The STI-100 is a contact closer screen trigger device. The STI-100 easily connects to any third party control system.
<b>Optional Control</b>		
Control	PowerOptions	Description
Cima-Link Infrared Kit Package Cima-Link Serial RS-232 Package Cima-Link Ethernet Package	120V / 220-240V	These three ad-on packages provide additional functionality to the standard Cima control. Please contact Stewart for additional details.

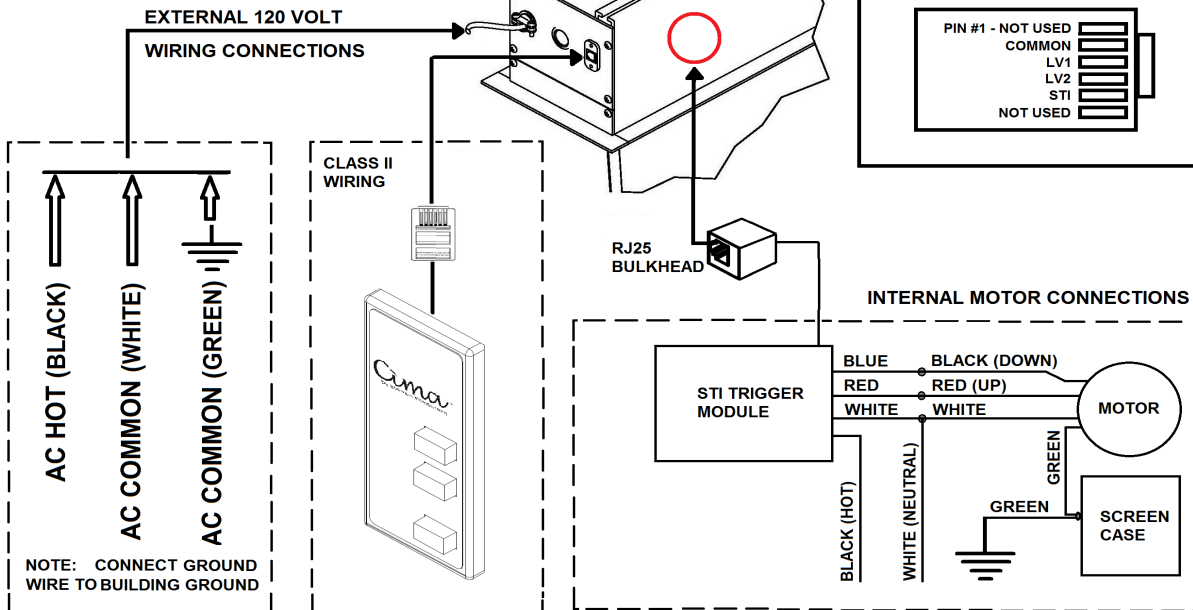
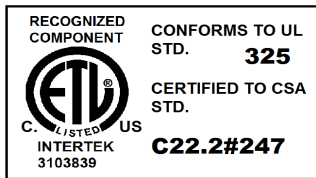

The STI-100 is a contact closer screen trigger device. The STI-100 easily connects to any third party control system.



The Reference for Stunning™

[www.stewartfilmscreen.com](http://www.stewartfilmscreen.com)

1161 W. Sepulveda Blvd., Torrance CA 90502 USA | 800.762.4999 | Tel: 310.784.5300 | Fax: 310.326.6870 | Email: request@stewartfilmscreen.com

©2021 Stewart Filmscreen. Specifications are subject to change without notice.